

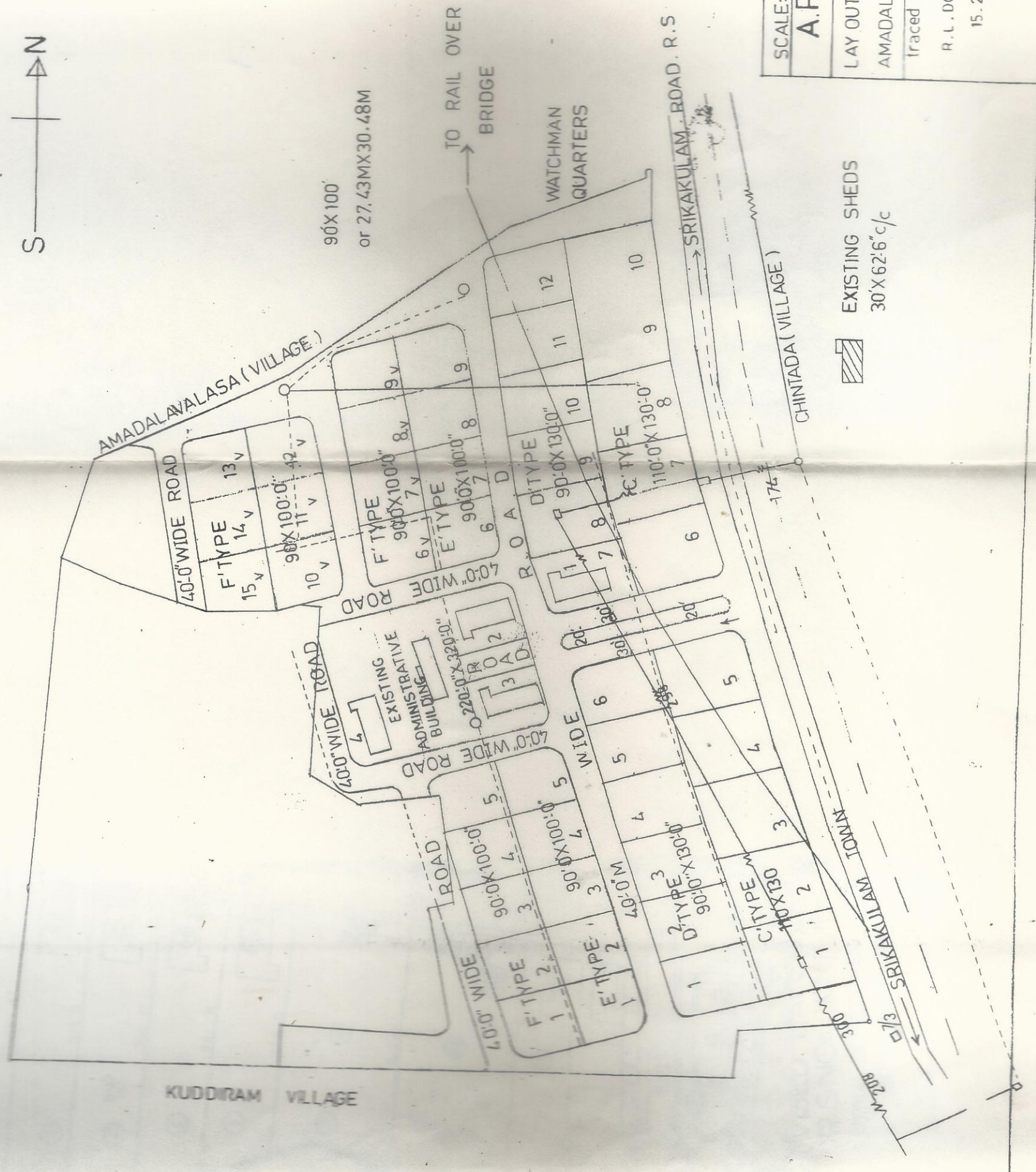

REFERENCE

total extent of land = 19.52 ac
 area occupied by roads = 4.91 ac
 total length of roads (1650mts) = 0.88 ac
 area of administrative building = 0.91 ac
 area unfit for development = 12.82 ac
 area of plots including sheds = 12.82 ac

no of plots available	total area	sq yds
10 nos	110'X130'	15889
12 nos	90'X130'	15000
9 nos	90'X100'	81000
15 nos	90'X100'	15000
46 nos		



SCALE:-1:100	DR.G.NO:-	DATE:-
A.P.I.I.C. LTD HYDERABAD		
LAY OUT OF INDUSTRIAL ESTATE AT AMADALAWALASA SRIKAKULAM (DIST)		
Traced by	sd ---	sd ---
R.L. DORA	zonal engineer	chief engineer
15.2.91		

EXISTING SHEDS
30'X62'6" c/c

KUDDIRAM VILLAGE