

DUPPITURU LAYOUT

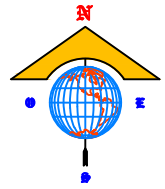

PROPOSED LAYOUT PLAN FOR INDUSTRIAL CLUSTER(NON-SEZ) DUPUTURU(VILLAGE), ATCHUTAPURAM (M) VISAKHAPATNAM.(DIST.)

SCALE: 1 : 100

LAND USE ANALYSIS

LAYOUT BOUNDARY		
PROPOSED ROADS		
EXISTING ROADS		
POSESSION HANDED OVER as per revenue records	ACS.126.18	(-) 24.97
DUPPITURU VILLAGE INCLUDING RESERVE AREA (10.97+14.00)	<u>ACS.101.21</u>	
TOTAL LAYOUT AREA	: 101.21Acs	100.00 %
PLOTTED AREA	: 70.04 Acs	69.20 %
ROAD AREA	: 9.96 Acs	9.84 %
ROAD AREA FALLEN UNDER WIDENING OF A-P ROAD	: 0.63 Acs	0.62 %
AMENITIES	: 4.05 Acs	4.00 %
OPEN SPACE AREA GREEN BELT & HT LINE AREA	: 9.01 Acs	8.91 %
Water Bodies Area	: 7.52 Acs	7.43 %

DETAILS OF VACANT LAND

BLOCK-I	: Acs. 10.00
BLOCK-II	: Acs. 9.61
BLOCK-III	: Acs. 0.90
BLOCK-IV	: Acs. 9.43
BLOCK-V	: Acs. 1.48
BLOCK-VI	: Acs. 0.77
BLOCK-VII	: Acs. 10.00
BLOCK-VIII	: Acs. 3.28
BLOCK-IX	: Acs. 1.80
TOTAL:	: Acs. 47.27

A.P.S.E.Z

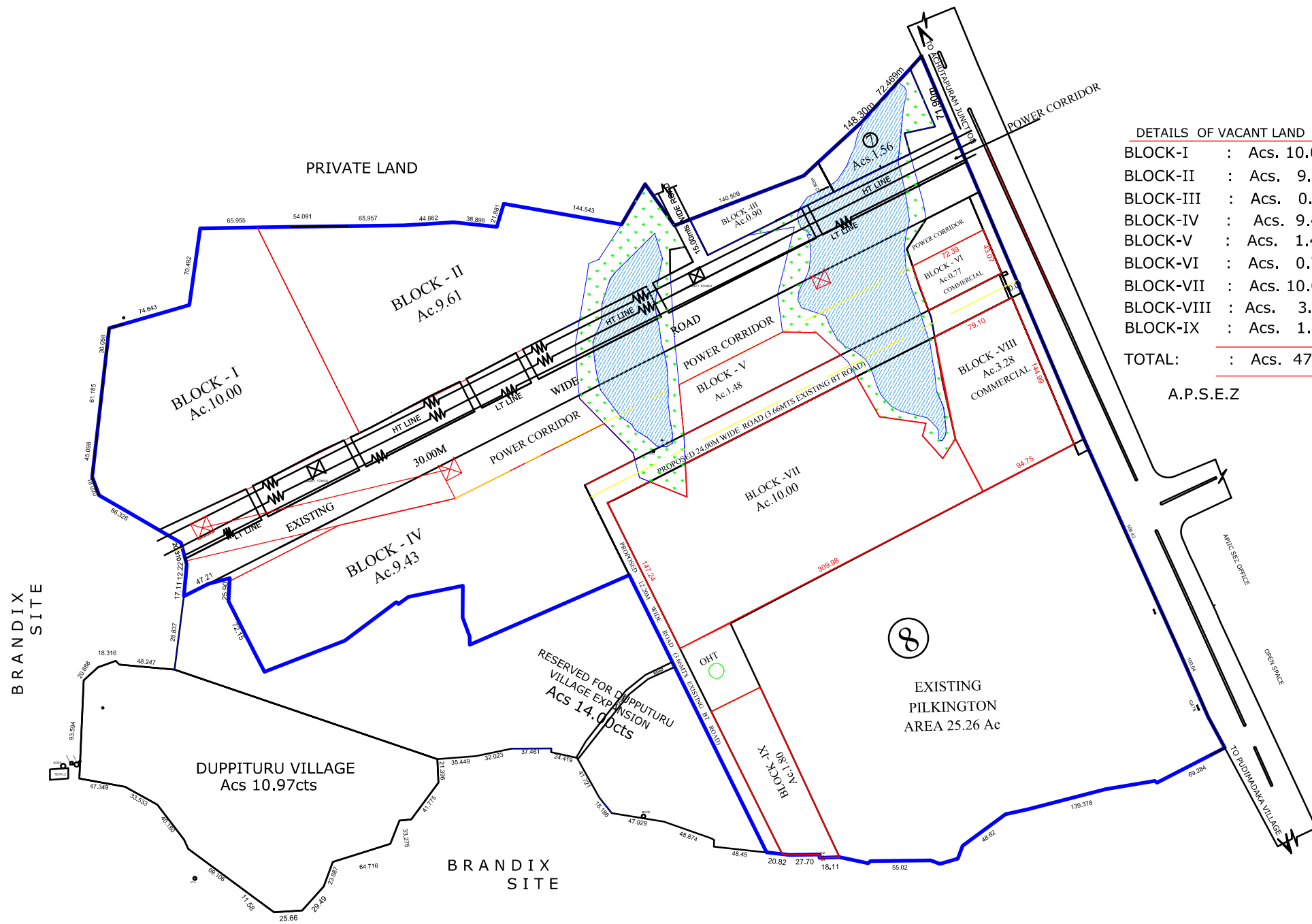

A.P.I.I.C.LTD.,

MANAGER/E

DY.GENERAL MANAGER/E

CHIEF ENGINEER -II
APIC LTD.