

L.P.NO:15/89

C.NO 21833/89/D8

REF NO.EW-T5/25(11)/89 DT:4.11.89

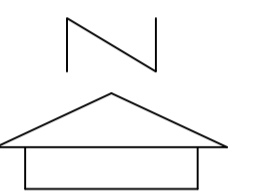

REFERENCE		
PROP ROADS		==
EXIST ROADS		==
EXIST ROADS		==
TOTAL AREA		AC 29.40
%OPEN SPACE	(5 %)	AC 1.47
%OF ROADS	(31 %)	AC 9.11
NO OF PLOTS		47
BUILDING LINE		20'-0"

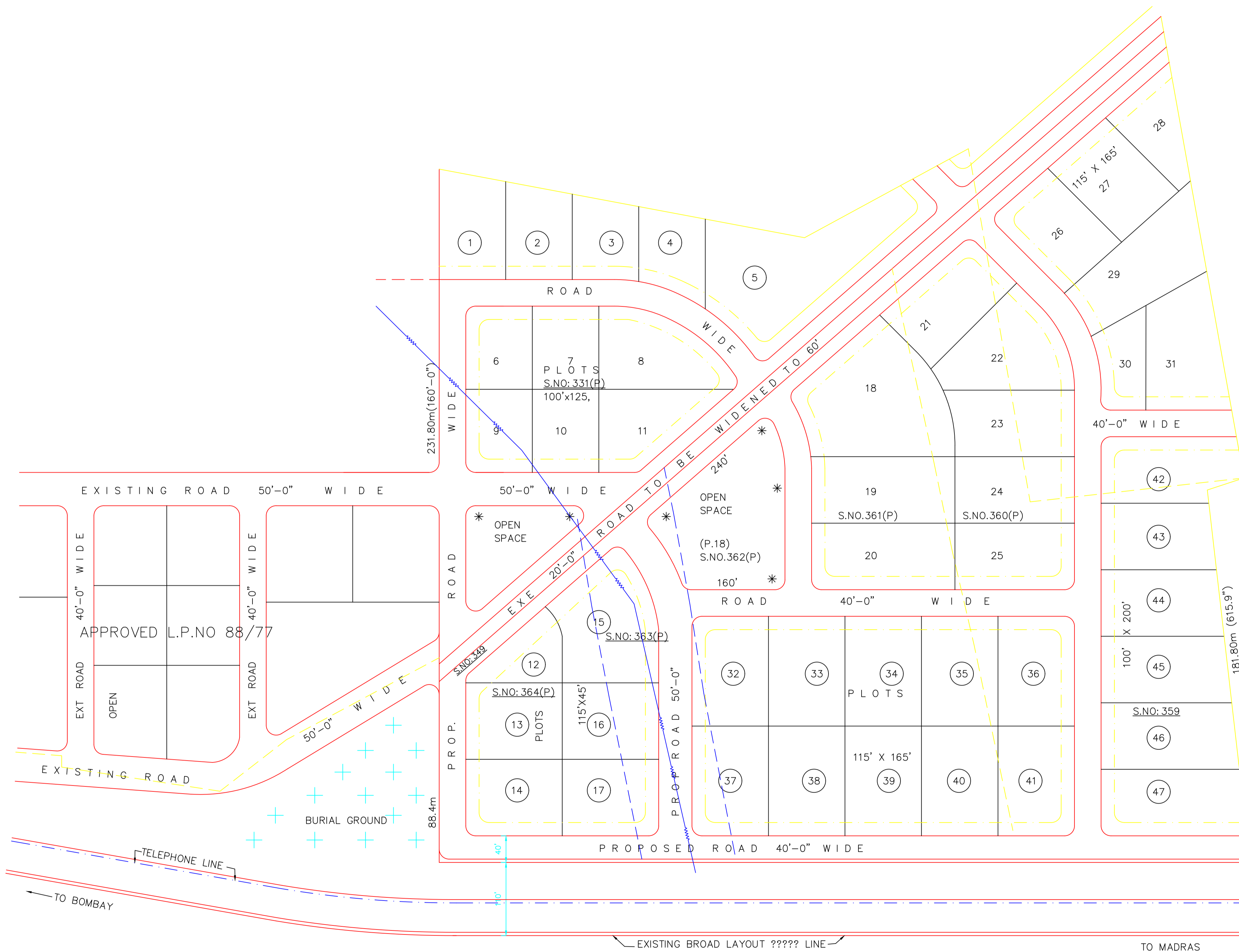

A.P.I.I.C. LTD. HYDERABAD  
PROPOSED LAYOUT PLAN FOR INDUSTRIAL  
ESTATE EXPANSTION AT YERAHUNTLA (V)  
CUDDAPAH DIST. (INS.NO5 33T/P TO 336/P 358/P TO 368(NH)  
TO AN INCH

DIRECTOR OF TOWN AND  
COUNTRY PLANNING A

/TRUE COPY