

PLAN SHOWING THE UNDEVELOPED LAND IN SY.NOS.717 AT KOTTAKI(V),
RAMABHADRAPURAM(M), VIZIANAGARAM DISTRICT

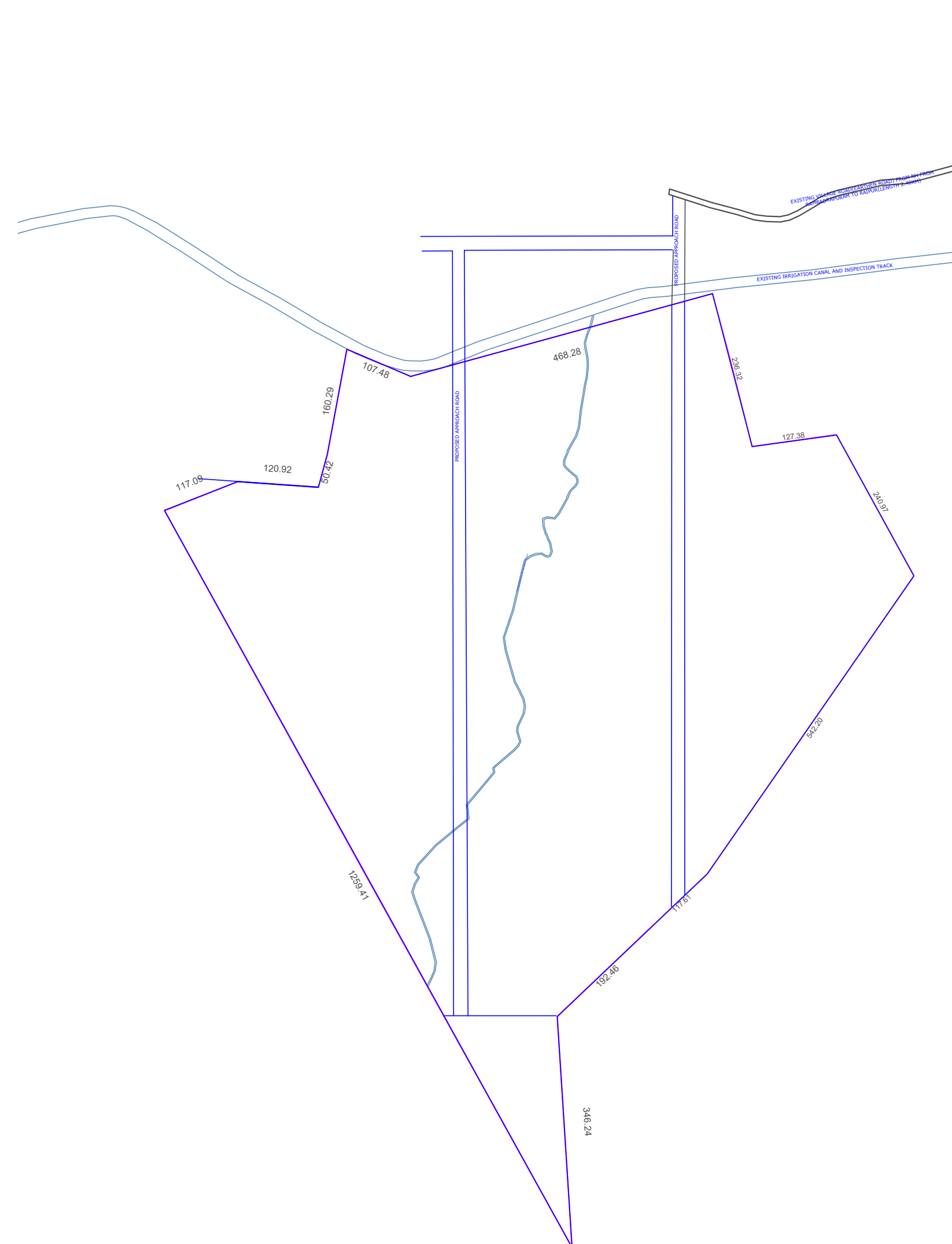

Plotted Area: Ac.182.08 cts
Road Area: Ac.5.00 cts
Total Extent: Ac.187.08 cts
All dimensions are in Metres