

REVISED LAY-OUT PLAN FOR INDUSTRIAL PARK AT AGANAMPUDI (V), VISAKHAPATNAM(D)

ANDHRAPRADESH INDUSTRIAL INFRASTRUCTURE CORPORATION

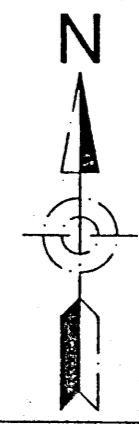

REVISED LAY - OUT PLAN FOR INDUSTRIAL PARK IN S.No. 181/P, 200/P, 201, 213/P OF AGANAMPUDI (V), GAJUWAKA (M), VISAKHAPATNAM Dist.

A.P.I.I.C.LTD HYDERABAD
LAND USE ANALYSIS

SL.No.	DESCRIPTION	EXTENT	PERCENTAGE
1.	TOTAL AREA	44.61	100.00%
2.	PLOTTED AREA	29.74	66.67%
3.	ROADS AREA	8.66	19.41%
4.	OPEN SPACE & GREEN BELT	4.46	10.00%
5.	C.F.C AREA	1.75	3.92%

PLOT DETAILS:

SL.No.	PLOT SIZE IN Mts.	PLOT AREA in Sqm.	NO. OF PLOTS
1	98.00X43.00	4214.00	1
2	213.00X74.00	15785.00	1
3	25.00X37.00	925.00	20
4	22.00X42.00	924.00	4
5	28.00X49.00	1375.42	1
6	25.00X38.00	950.00	2
7	25.00X50.00	1250.00	2
8	30.00X42.00	1260.00	1
9	25.00X40.00	1000.00	1
10	30.00X38.00	1140.00	1
11	36.00X44.00	1584.00	2
12	25.00X42.00	1050.00	2
13	20.00X53.00	1060.00	1
14	27.00X62.00	1674.00	1
15	37.00X50.00	1850.00	1
16	28.00X53.00	1484.00	1
17	27.00X37.00	999.00	11
18	27.00X55.70	1504.00	7
19	16.40X55.90	916.30	1
20	21.90X41.90	916.75	1
21	27.00X40.00	1080.00	21
22	32.00X39.00	1248.00	2
23	37.00X78.00	2886.00	1
24	27.00X32.00	864.00	1
25	27.00X35.00	945.00	1
26	38.00X42.00	1596.00	1
27	32.00X40.00	1280.00	1
28	25.00X29.00	725.00	1
29	13.00X47.00	611.00	1
30	27.00X42.00	1134.00	1

Total No of Plots : 93 Nos

L.P.No: 56/2013 (This revises the original layout Approved vide L.P.No: 42 /2011&61/2012).

OWNER'S SIGN
ZONAL MANAGER
APIIC, VISAKHAPATNAM. SCALE : 1:20

VICE-CHAIRMAN

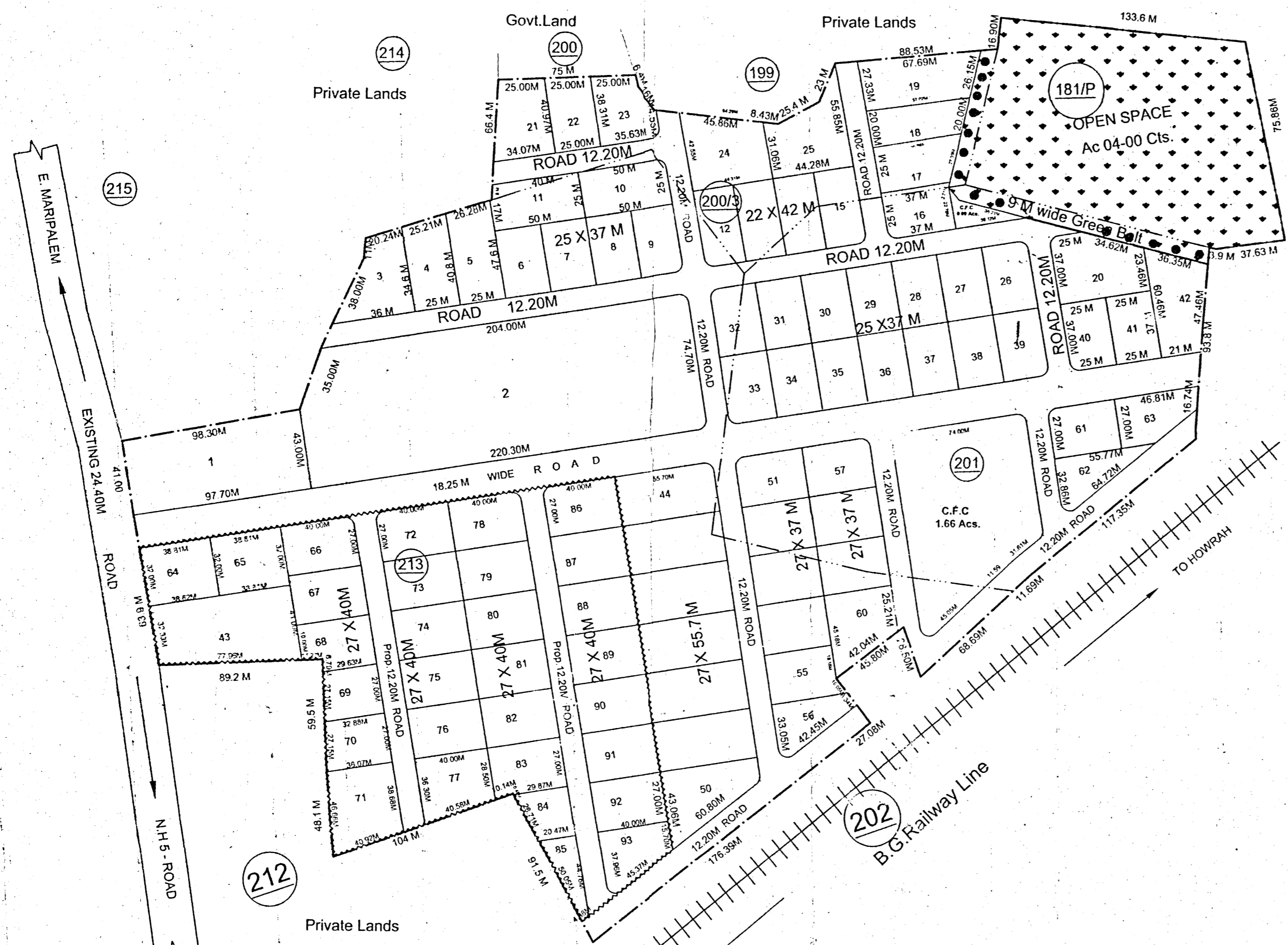

APPROVED, Vide Progs...R.S...No. 18330 /...Dt... Subject to the following conditions.

For VICE CHAIRMAN
Urban Development Authority
Visakhapatnam

K.V.J. Rao
S/O MAP 11/11/13
P.O
CHIEF URBAN PLANNER

VISAKHAPATNAM URBAN DEVELOPMENT AUTHORITY