

C.NO.2795/2015/A

REF.NO. 476/2015/A6, DT: 09-04-2018, OF RDDTP, ANANTAPURAMU

TLP NO: 24-/2018/A

EXTRACT OF PRODDATUR MASTER PLAN SITE UNDER REFERENCE

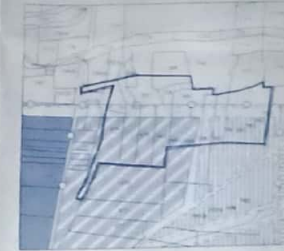

**CAUTION:**  
THIS LAYOUT IS LEGALLY VALID ONLY ON ITS RELEASE/APPROVAL BY THE CONCERNED GRAM PANCHAYAT UNDER SECTION 121 A P.P.R. ACT 1984 AND UNDER RULE 11 (3) OF G.O. 67 PH & RD. Dt.28-02-2002 ON FULFILLMENT OF ALL LAYOUT CONDITIONS ANY TRANSACTIONS PRIOR TO THE ABOVE IS ILLEGAL.

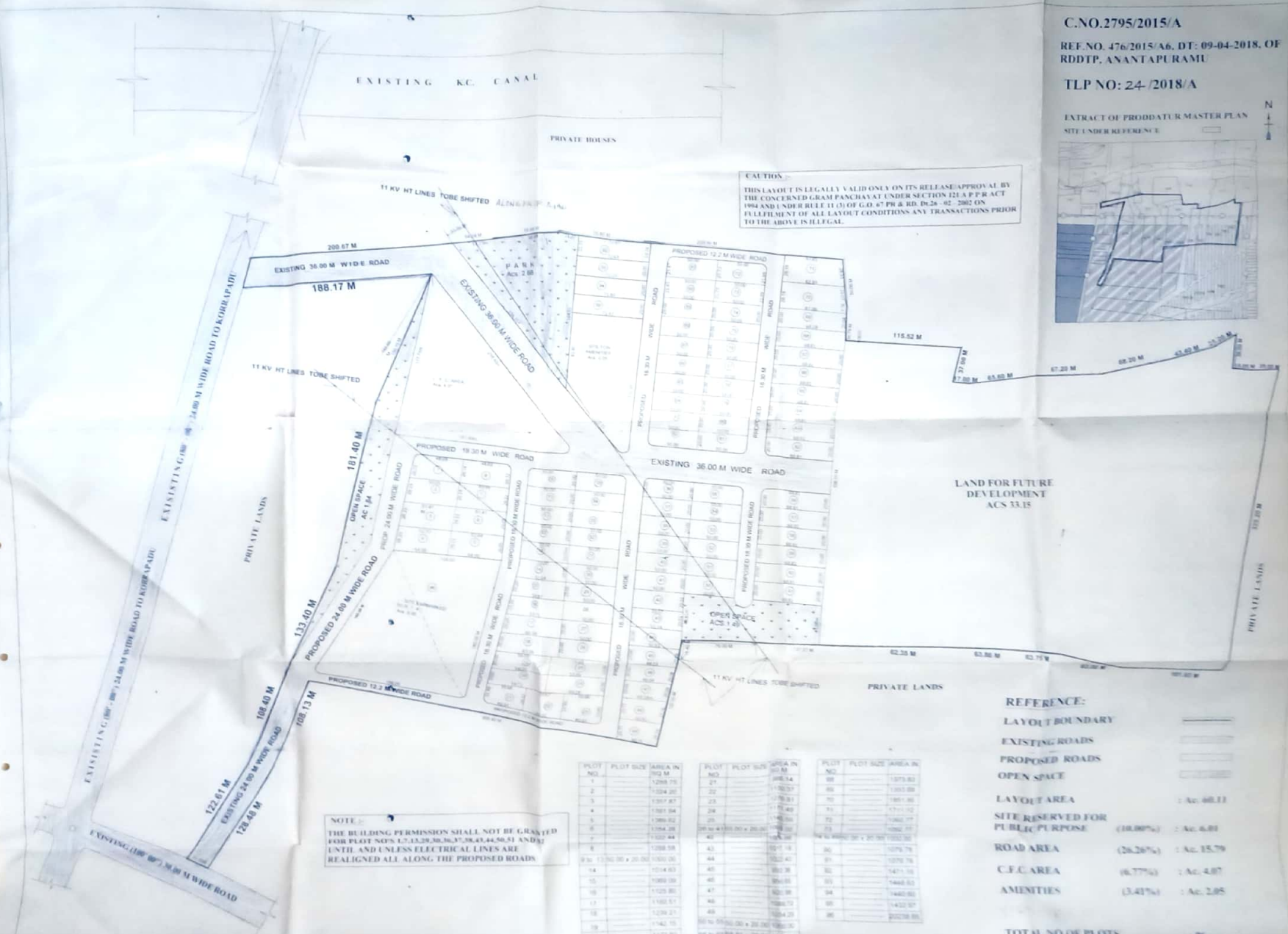

**NOTE:**  
THE BUILDING PERMISSION SHALL NOT BE GRANTED FOR PLOT NOS. 17, 13, 28, 36, 47, 28, 43, 44, 56, 51 AND 51 UNTH. AND UNLESS ELECTRICAL LINES ARE REALIGNED ALL ALONG THE PROPOSED ROADS.

1	2	3	4	5	6	7	8	9	10	11	12	13	14	15	16	17	18	19	20	21	22	23	24	25	26	27	28	29			
1288.25	1224.20	1207.87	1207.84	1200.82	1184.28	1120.44	1288.58	1320.00	1214.63	1080.30	1120.80	1180.57	1229.27	1142.10	1172.90	1288.25	1224.20	1207.87	1207.84	1200.82	1184.28	1120.44	1288.58	1320.00	1214.63	1080.30	1120.80	1180.57	1229.27	1142.10	1172.90

**REFERENCE:**

LAYOUT BOUNDARY	---
EXISTING ROADS	---
PROPOSED ROADS	---
OPEN SPACE	---
LAYOUT AREA	: Ac. 60.11
SITE RESERVED FOR PUBLIC PURPOSE (10.00%)	: Ac. 6.01
ROAD AREA (26.26%)	: Ac. 15.79
C.F.C. AREA (6.77%)	: Ac. 4.07
AMENITIES (3.41%)	: Ac. 2.05
<b>TOTAL NO OF PLOTS</b>	<b>: 26</b>

APIC LIMITED  
TECHNICAL LAYOUT PATERN FOR INDUSTRIAL PARK IN SY.NOS. 673, 675/1A, 2D1, 2A1, 2B1, 2C1, 3A, 676, TO 681, 682/1A & 2A, 683/1A, 2A, 3A, 684/1, 685/1, 686/1A, 2A, 3A, 687/1A, 2A, 3A, 701/1, 704/1A, 2A, 1, 2B1, 705/1A, 155/A-2, 159/A-2B, 160/A-2, 161/A-1, 190/1 OF PRODDATUR & 205/2/201B, 206-2, 207, 208, 209/1B&2B, 210/A-1A OF GOPAVARAMU, PRODDATUR MANDAL, YSR KADAPA DISTRICT.

A.D.M. ASST. DIRECTOR DEPUTY DIRECTOR DIRECTOR OF TOWN & COUNTRY PLANNING GOVT. OF A.P., GUNTUR