

C. No. 10234 / 2009 / G

REF.No. ADV-1/APIIC/AMF/IIDC-Tada/07,DT.09-12-2009,
OF ADVISOR-1,APIIC Ltd-HYDERABAD,

T.L.P. No. 29 / 2010 / G/APIIC
(THIS REVISES L.P.No. 1 / 1996 / APIIC)
(THIS REVISES D.T.L.P.No. 9054/2006/103/N)

CAUTION : -
THIS LAYOUT IS LEGALLY VALID ONLY ON ITS RELEASES/APPROVAL
BY THE CONCERNED GRAM PANCHAYAT UNDER SECTION 121 OF
A.P.P.R ACT 1994 AND UNDER RULE 11(3) OF G.O.M.S.NO.67 PR & R.D
DT.26-02-2002, ON FULFILMENT OF ALL LAYOUT CONDITIONS.
ANY TRANSACTION PRIOR TO THE ABOVE IS ILLEGAL.
ILLEGAL.

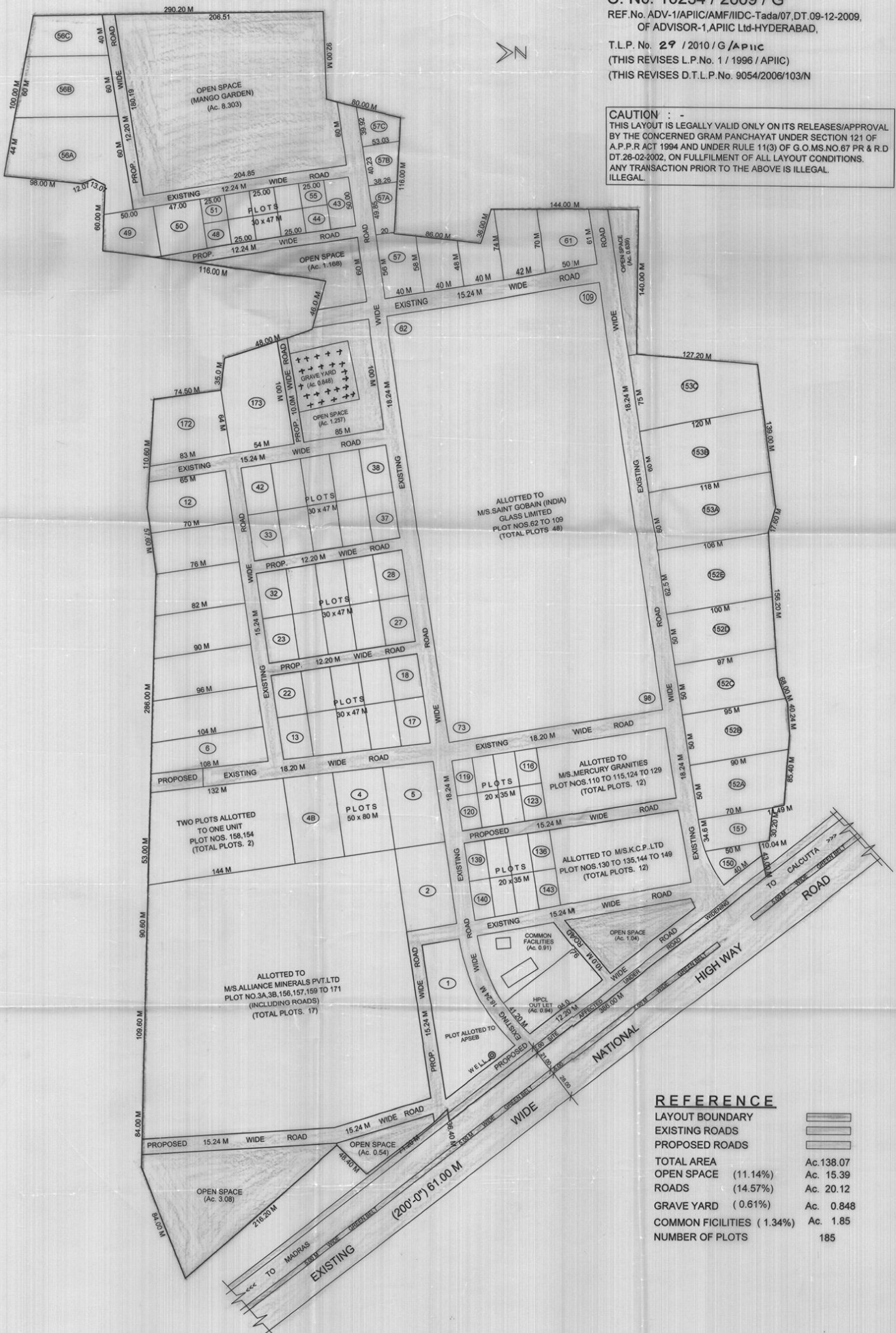

REFERENCE

LAYOUT BOUNDARY	▬▬▬▬▬
EXISTING ROADS	▬▬▬▬▬
PROPOSED ROADS	▬▬▬▬▬
TOTAL AREA	Ac.138.07
OPEN SPACE (11.14%)	Ac. 15.39
ROADS (14.57%)	Ac. 20.12
GRAVE YARD (0.61%)	Ac. 0.848
COMMON FACILITIES (1.34%)	Ac. 1.85
NUMBER OF PLOTS	185

TADA GRAM PANCHAYAT APIIC
REVISED TECHNICAL LAYOUT PATTERN FOR THE SITE IN S.Nos. 59/1,
57,58,54/4p,55/p,225,226,230,233,236,201,203,201/6A,203/10A-13A OF TADA,
NELLORE DISTRICT.
SCALE : - 1 : 2000

[Signature]
DEPUTY DIRECTOR

[Signature]
JOINTY DIRECTOR (M.P.T)

[Signature]
A.D.M

[Signature]
TOWN PLANNING ASST.

[Signature]
DIRECTOR OF TOWN & COUNTRY PLANNING
GOVT. OF A.P.,HYDERABAD.