

FILE NO:

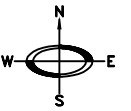

EXTRACT OF TANGADANCHA VILLAGE SCALE: Not to scale SITE U/R:

KEY MAP TANGADANCHA VILLAGE

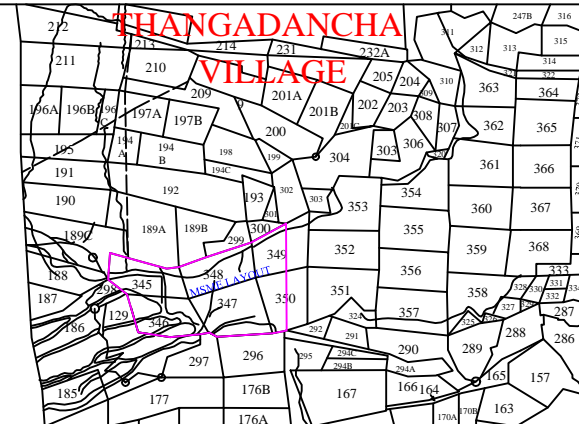

REFERENCES:

- PROPOSED LAYOUT BOUNDARY :
- PROPOSED SURVEY BOUNDARY :
- PROPOSED ROADS :
- EXISTING ROADS :
- OPEN SPACE :
- COMMON AMENITY (Saleable) :
- COMMON UTILITY (Non-Saleable) :
- VAGU PORTION :

LAND USE ANALYSIS:-

- PROPOSED LAYOUT AREA : Ac 50.00 Cents
- A).ROADS AREA (27.66%): Ac 13.83 Cents
- B).CANAL AREA (11.12%): Ac 5.56 Cents
- C).RECREATIONAL:- (11.94%)
- i).OPEN SPACE AREA (07.60%): Ac 3.80 Cents
- ii).CANAL BUFFER (04.34%): Ac 2.17 Cents
- D).COMMON AREA :- (04.92%)
- i).COMMON AMENITY (03.30%): Ac 1.65 Cents (Saleable)
- ii).COMMON UTILITY (01.62%): Ac 0.81 Cents (Non-Saleable)
- E).PLOTTED AREA (44.36%): Ac 22.18 Cents
- NUMBER OF PLOTS : 256 Nos

APIIC Ltd.,VIJAYAWADA,
PROPOSED MSME LAYOUT IN SY.NOS:-
345;346;347;348;349(P) AND 350(P) AT
TANGADANCHA(V), JUPADUBUNGLOW
(M), KURNOOL DISTRICT.
SCALE:1:500

| | | | | |
|---|----------|-------|-------------------|-------------------------|
| VICE-CHAIRMAN & MANAGING DIRECTOR A.P.I.I.C VIJAYAWADA | | | | |
| M(E) | DGM(E)-I | GM(E) | J.D. (T & C.P) | CHIEF ENGINEER SOUTH |