

Revised Site Plan for Plot No 2E at IC-PUDI

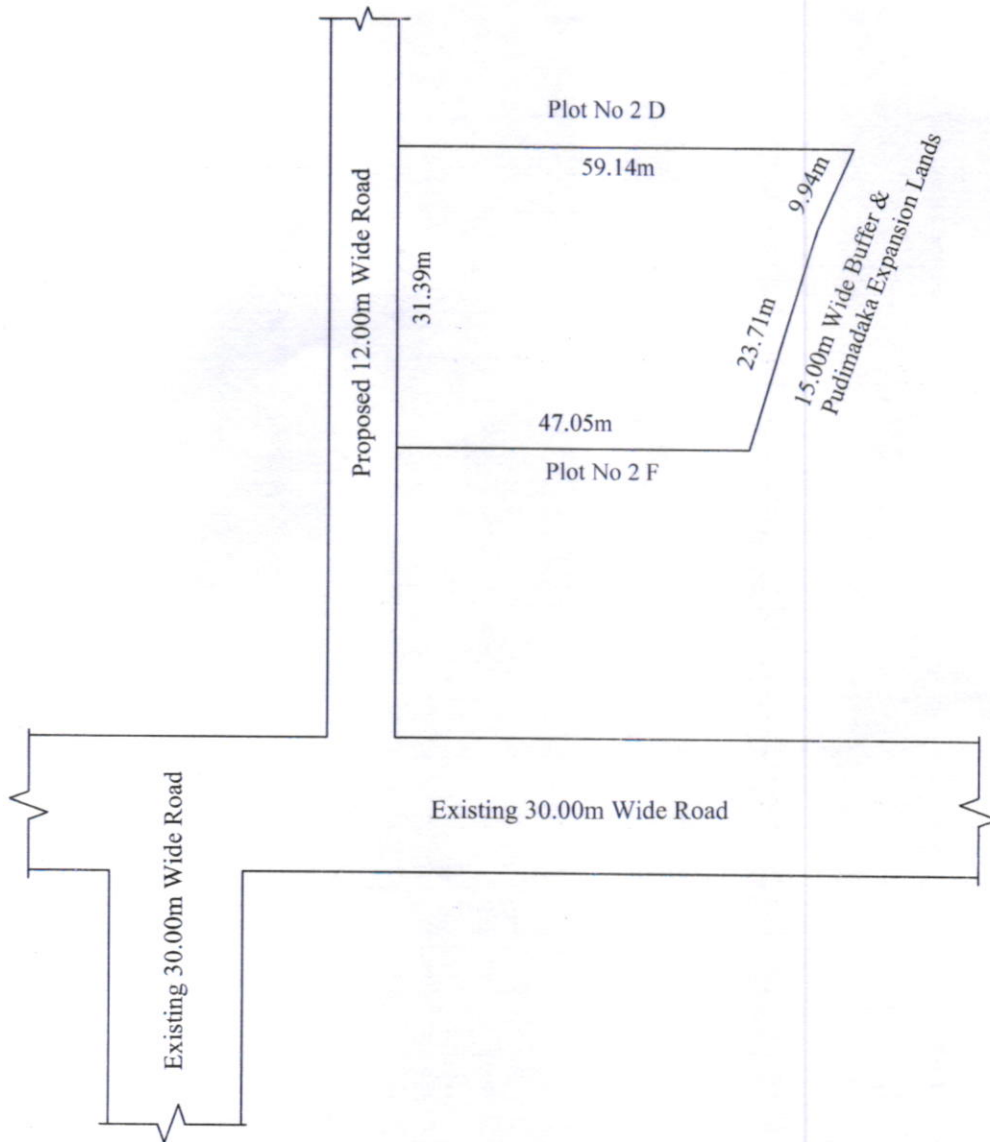

Total Area: Ac 0.41 cts or 1659.56 Sqm

Boundaries:

North :Plot No 2D

South :Plot No 2F

East :15.00m Wide Buffer & Pudimadaka Expansion Lands

West :Proposed 12.00m Wide Road

Sr. Project Engineer 04/03/2021

Dy. Zonal Manager 04/03/2021