

**Site Plan for Plot No 20A in Sy no's 370(P),371(P),378(P) of IC-PUDI,Rambilli Mandal.**

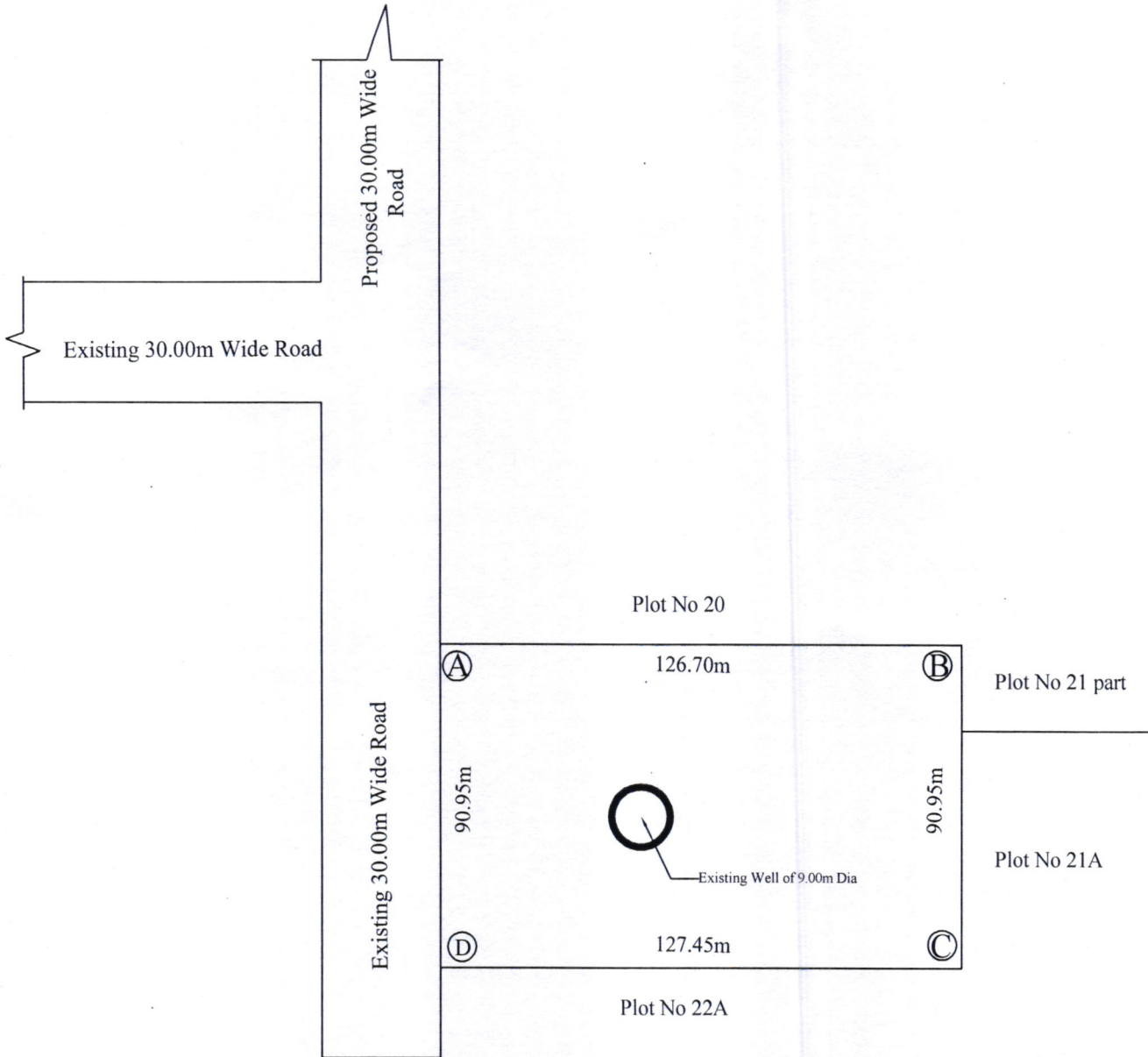

Total Area: Ac 2.86 cts or 11557.42 Sqm

**Boundaries:**

North :Plot No 20  
 South :Plot no 22A  
 East :Plot No 21 Part & Plot No 21A  
 West :Existing 30.00m Wide Road

**Co-ordinates:**

A -  $17^{\circ}30'28.93''N$   
 $83^{\circ}59'55.76''E$   
 B -  $17^{\circ}30'29.48''N$   
 $83^{\circ}0'0.04''E$   
 C -  $17^{\circ}30'26.55''N$   
 $83^{\circ}0'0.41''E$   
 D -  $17^{\circ}30'26.00''N$   
 $82^{\circ}59'56.13''E$



Sr.Project Engineer

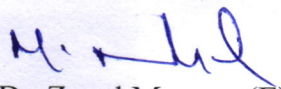

Dy.Zonal Manager(E)



Zonal Manager