

Site Plan for Plot No. 13 at IC : Pudi

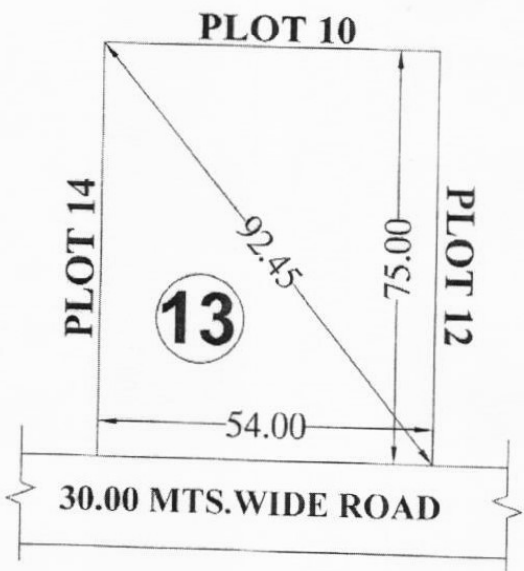

Area of the Plot = 4050 sq.mt
1.001 Ac

BOUNDARIES

- NORTH : PLOT NO 10
- EAST : PLOT NO 12
- SOUTH : 30 M WIDE ROAD
- WEST : PLOT NO 14

[Signature]
 ZONAL MANAGER
 APIIC LIMITED
 SPECIAL PROJECTS ZONE
 ONE STOP SERVICE CENTRE
 APSEZ ATCHUTAPURAM
 VISAKHAPATNAM - 531 011.

For KOLAMALA HEAVY INDUSTRIES
[Signature] Proprietor