

**Site Plan for Plot No 18 in Sy no's 259(P),376(P),377(P)**  
**of IC-PUDI,Rambilli Mandal.**

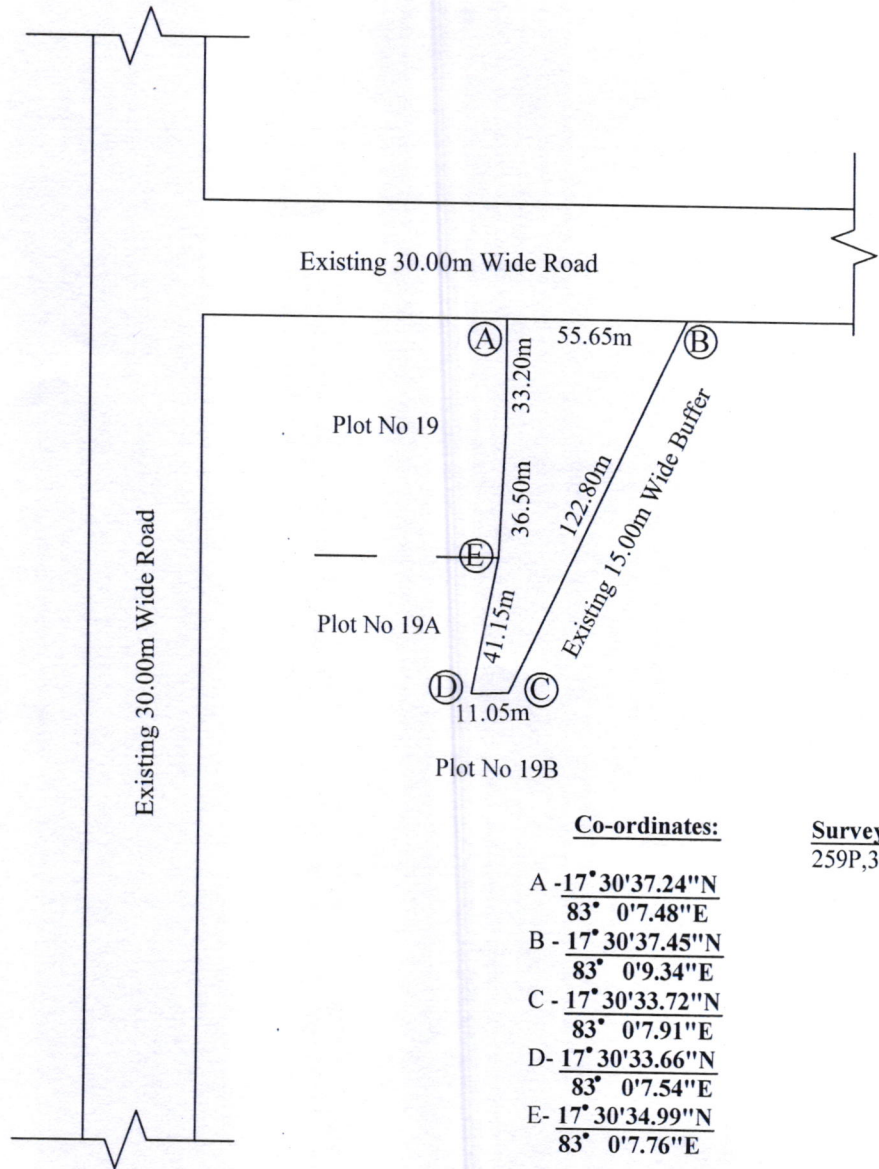

**Co-ordinates:**

**Survey No's:**  
259P,376P,377P

- A -  $17^{\circ}30'37.24''N$   
 $83^{\circ}0'7.48''E$
- B -  $17^{\circ}30'37.45''N$   
 $83^{\circ}0'9.34''E$
- C -  $17^{\circ}30'33.72''N$   
 $83^{\circ}0'7.91''E$
- D -  $17^{\circ}30'33.66''N$   
 $83^{\circ}0'7.54''E$
- E -  $17^{\circ}30'34.99''N$   
 $83^{\circ}0'7.76''E$

Total Area: Ac 0.79 cts or 3228.44 Sqm

**Boundaries:**

- North :Existing 30.00m Wide Road
- South :Plot No 19B
- East :Existing 15.00m Wide Buffer
- West :Plot No 19 & Plot No 19A

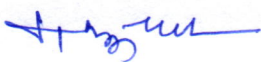
  
Sr.Project Engineer

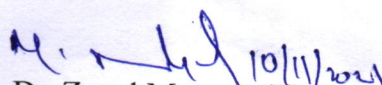
  
Dy.Zonal Manager(E)

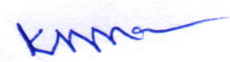
  
Zonal Manager