

SITE PLAN FOR PLOT NO 21 AT IC-PUDI

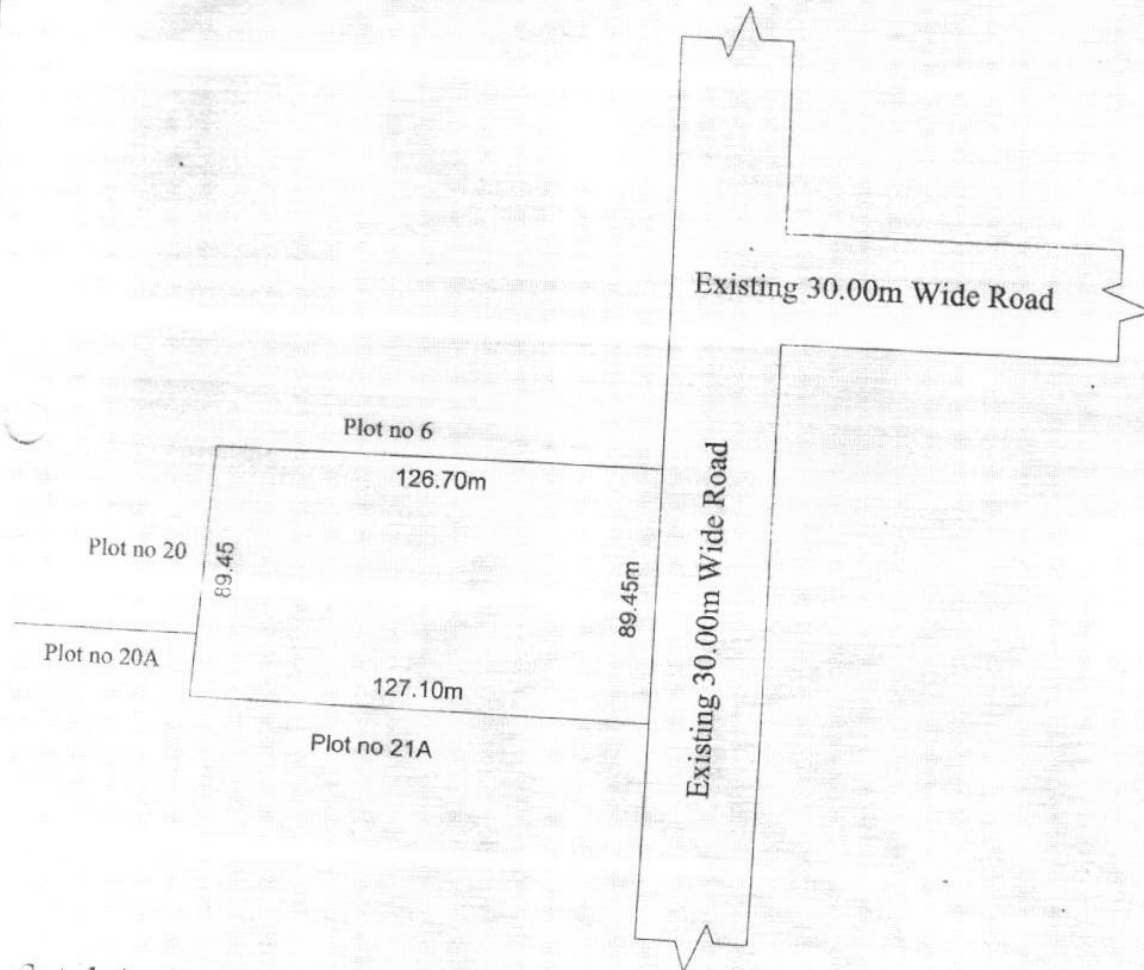
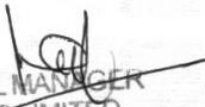

Total Area : Ac.2.80 or 11350.69 Sqm

ZONAL MANAGER
APHC LIMITED
SPECIAL PROJECTS ZONE
ONE STOP SERVICE CENTRE
APSEZ ATCHUTAPURAM
VISA KHAPATNAM - 521 01

Boundaries:

North : Plot No 6
South : Plot No 21A
East : Existing 30.00m Wide Road
West : Plot No 20, Plot No 20A

Note:

1. The Layout is subject to approval of competent authority.
2. The Sub-division of plots is subject to approval of competent authority.

For CLASSY KONTAINERS

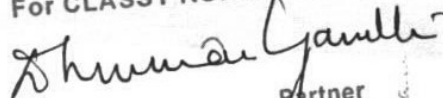
Partner