

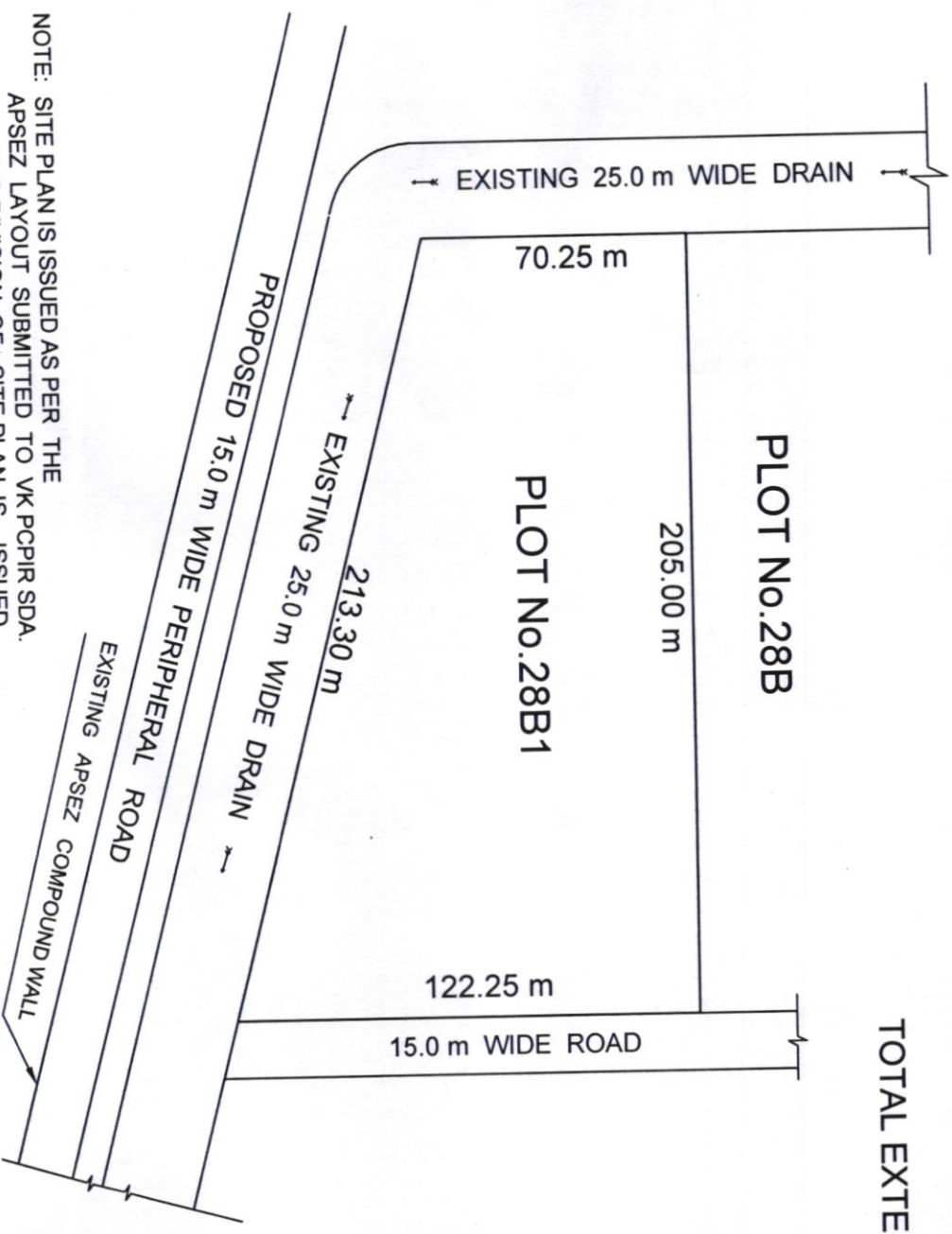

BOUNDARIES:

- NORTH: PLOT No.28B
- SOUTH: APSEZ COMPOUND WALL, PROPOSED 15.0m WIDE PERIPHERAL ROAD AND EXISTING 25.0 m WIDE EXISING DRAIN.
- EAST: 15.0 m WIDE ROAD
- WEST : EXISTING 25.0 m WIDE DRAIN

TOTAL EXTENT OF PLOT No.28B1 = 19796.00 Sq.mt.



NOTE: SITE PLAN IS ISSUED AS PER THE APSEZ LAYOUT SUBMITTED TO VK PCPIR SDA. THE SUB DIVISION OF SITE PLAN IS ISSUED SUBJECTED TO APPROVAL OF LAYOUT BY VK PCPIR SDA.

[Signature]
DY. ZONAL MANAGER (E)
 APJIC, APSEZ,
 ATCUTTADIIRAM

[Signature]
ZONAL MANAGER
 SPECIAL PROJECTS ZONE
 APJIC LIMITED
 VISAKHAPATNAM

[Signature]

NOTE: ALL DIMENSIONS ARE IN METRES.
 SCALE: 1:2000

APJIC Ltd., MANGALAGIRI

SITE PLAN SHOWING THE PLOT Nos. 28B1 IN SURVEY Nos. 75p, 76p OF LALAMKODURU VILLAGE, RAMBILLI MANDAL, APSEZ LAYOUT , VISAKHAPATNAM DISTRICT.