

BOUNDARIES

- NORTH : Plot No. 28C1/A & 28C1
- SOUTH : Plot No. 28C1A
- EAST : Plot No. 29
- WEST : EXISTING 15.00 WIDE 14th Cross ROAD

EXTENT OF PLOT No. 28C1/B = 1397 Sqm.

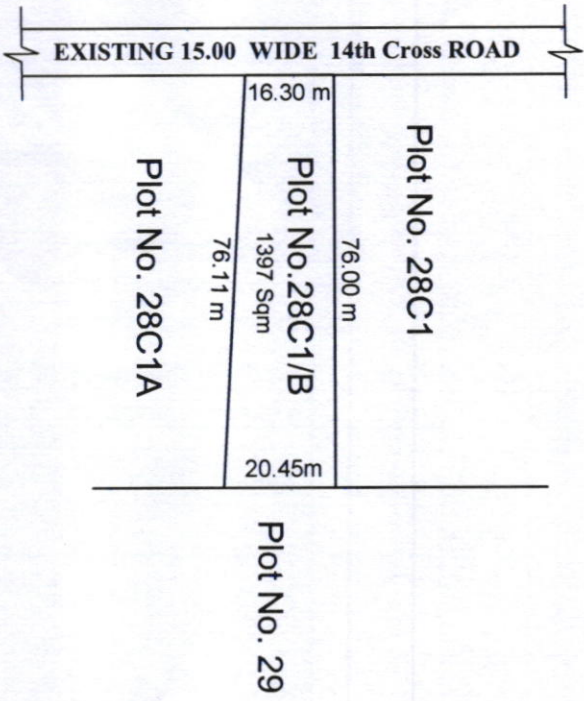

NOTE: SITE PLAN IS ISSUED SUBJECTED TO APPROVAL OF LAYOUT BY VK PCPIR SDA.

[Signature]
 Dy. ZONAL MANAGER (E)
 APIIC, APSEZ,
 ATCHUTAPURAM

[Signature]
 ZONAL MANAGER
 SPECIAL PROJECTS ZONE
 APIIC LIMITED
 VISAKHAPATNAM

NOTE: ALL DIMENSIONS ARE IN METRES.
 SCALE:

APIIC Ltd., MANGALAGIRI.

SITE PLAN SHOWING THE PLOT No. 28C1/B IN SURVEY No.76p OF LALAMKODURU VILLAGE, RAMBILLI MANDAL, APSEZ LAYOUT, VISAKHAPATNAM DISTRICT.