

Plot No. 63A

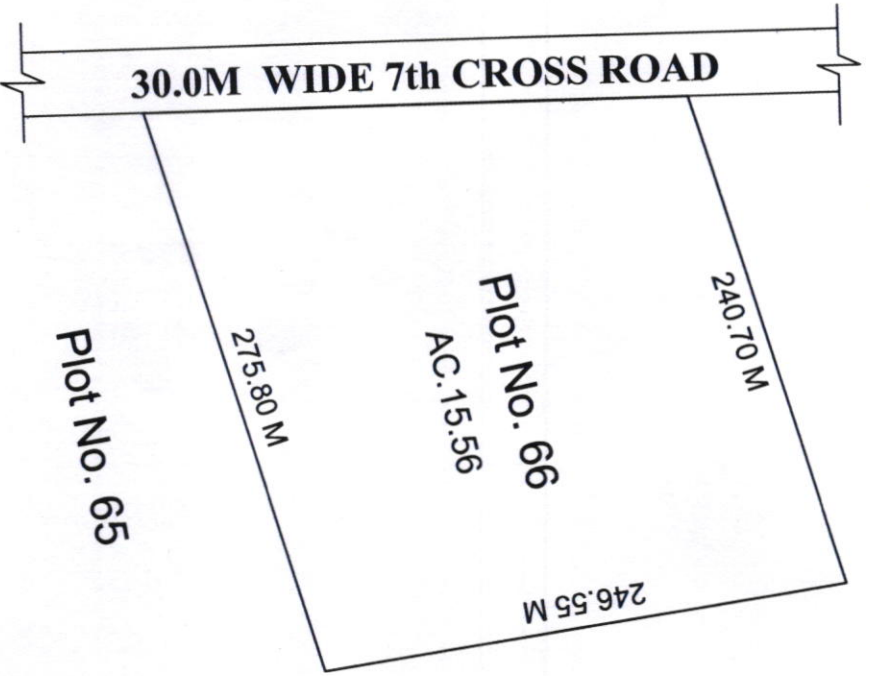

Plot Nos.
67A & 67B

BOUNDARIES:

NORTH: Plot No. 63A
 SOUTH: Plot No. 65
 EAST : Plot No.s 67A & 67B
 WEST : 30.0M WIDE 7th CROSS ROAD

EXTENT OF PLOT No. 66 = 62994.00 Sq.mt.
 or Ac. 15.56 Cts

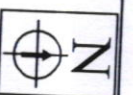

NOTE: SITE PLAN IS ISSUED SUBJECTED TO APPROVAL OF LAYOUT BY
 VK PCPIR SDA.

[Signature]
 DY. ZONAL MANAGER (E)
 APIIC, APSEZ,
 ATCHUTAPURAM

[Signature]
 ZONAL MANAGER
 SPECIAL PROJECTS ZONE
 APIIC LIMITED
 VISAKHAPATNAM

NOTE: ALL DIMENSIONS ARE IN METRES.
 SCALE:

APIIC Ltd., MANGALAGIRI.

SITE PLAN SHOWING THE PLOT No. 66 IN SURVEY
 Nos. 302p, 303p, 286p OF PUDI VILLAGE, RAMBILLI
 MANDAL, DENOTIFIED AREA, APSEZ LAYOUT,
 VISAKHAPATNAM DISTRICT.