

BOUNDARIES:

- NORTH: Plot No. 64A
- SOUTH: Plot No. 67A & 67B
- EAST : Proposed 30 Mts wide road
- WEST : Plot No. 66

EXTENT OF PLOT No. 67B1 = 24328.00 Sq.mt.
or Ac. 6.01 Cts

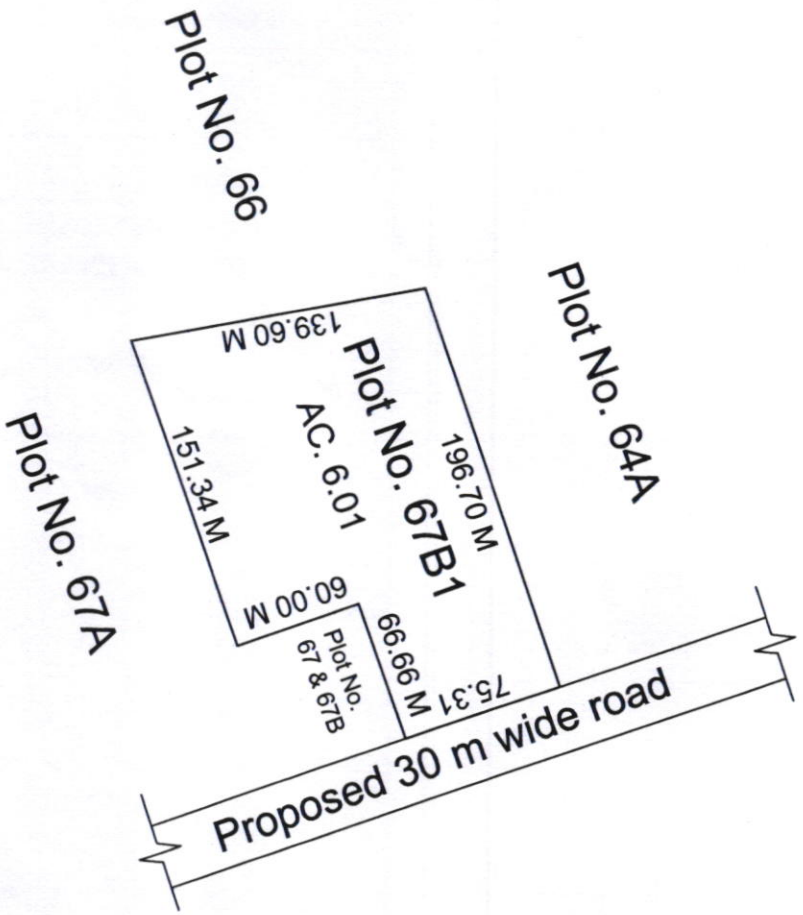

NOTE: SITE PLAN IS ISSUED SUBJECTED TO APPROVAL OF LAYOUT BY
VK PCPIR SDA.

Very
for Saravali
DR. ZONAL MANAGER (E)
APIIC, APSEZ,
ATCHUTAPURAM

Kumar
ZONAL MANAGER
SPECIAL PROJECTS ZONE
APIIC LIMITED
VISAKHAPATNAM

NOTE: ALL DIMENSIONS ARE IN METRES.
SCALE:

APLIC Ltd., MANGALAGIRI.

SITE PLAN SHOWING THE PLOT No. 67B1 IN SURVEY
Nos. 272p, 286p, 287p OF PUDI VILLAGE, RAMBILLI
MANDAL, DENOTIFIED AREA, APSEZ LAYOUT,
VISAKHAPATNAM DISTRICT.