

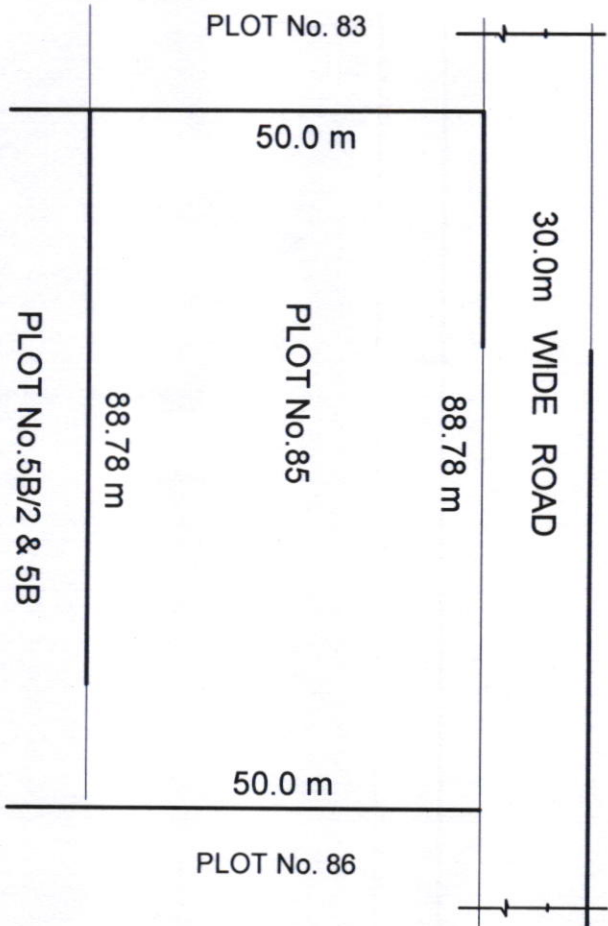

BOUNDARIES:

NORTH: 30.00m WIDE 9th MAIN ROAD  
SOUTH: PLOT No.5B/2 & 5B  
EAST : PLOT No. 86  
WEST : PLOT No. 84

TOTAL EXTENT OF PLOT No. 85 = 4439.00 Sq.mt.



NOTE: SITE PLAN IS ISSUED AS PER THE APSEZ LAYOUT SUBMITTED TO VK PCPIR SDA.  
THE SUB DIVISION OF SITE PLAN IS ISSUED SUBJECTED TO APPROVAL OF LAYOUT BY  
VK PCPIR SDA.

*Handwritten signature in blue ink.*

*Kp Saee Dis 9/11/24*  
**DY. ZONAL MANAGER (i)**  
**APIIC, APSEZ,**  
**ATCHUTAPURAM**

*Handwritten signature in blue ink.*  
**ZONAL MANAGER**  
**SPECIAL PROJECTS ZONE**  
**APIIC LIMITED**  
**VISAKHAPATNAM**

NOTE: ALL DIMENSIONS ARE IN METRES.  
SCALE: 1:1000

**APIIC Ltd., MANGALAGIRI**

**SITE PLAN SHOWING THE PLOT No. 85 IN**  
**SURVEY Nos.64p, 65p, 66p, 69p OF**  
**GURAJPALEM VILLAGE, DENOTIFIED AREA,**  
**APSEZ LAYOUT , VISAKHAPATNAM**  
**DISTRICT.**