

SITE PLAN SHOWING PLOT No : 89 OF APSEZ, ATCHUTAPURAM MANDAL, VISAKHAPATNAM DISTRICT.

BOUNDARIES:

NORTH: EXISTING 30.00 m WIDE 9th MAIN ROAD
SOUTH: BUFFER ZONE, EXISTING WATER BODY (SURVEY No.94)
& PLOT NO: 5D/1
EAST : PLOT No 88
WEST : PLOT NO : 90

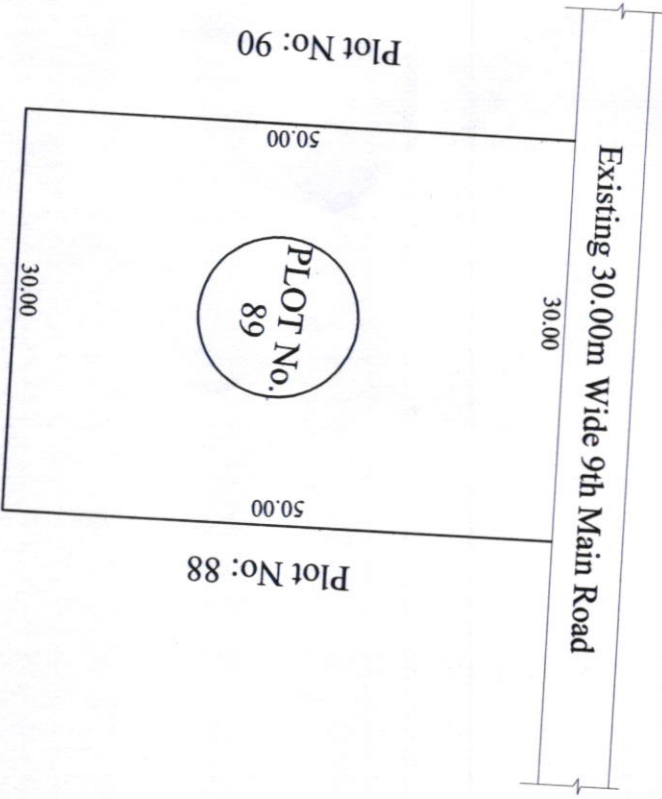

Buffer zone, Existing water body (SURVEY No.94) & Plot No: 5D/1

TOTAL EXTENT OF PLOT No.89 = 1500.00 Sq.mt.

NOTE: SITE PLAN IS ISSUED SUBJECT TO APPROVAL OF LAYOUT BY COMPETENT AUTHORITY.

NOTE: ALL DIMENSIONS ARE IN METRES.

Signature
9/11/24
DR. ZONAL MANAGER (..)
APIIC, APSEZ,
ATCHUTAPURAM

Signature
ZONAL MANAGER
SPECIAL PROJECTS ZONE
APIIC LIMITED
VISAKHAPATNAM

APIIC Ltd., MANGALAGIRI.
SITE PLAN SHOWING THE PLOT No.89 IN SURVEY Nos. 34p, 67p OF GURAJAPALEM VILLAGE, RAMBILLI MANDAL, DENOTIFIED AREA, APSEZ LAYOUT , RAMBILLI MANDAL, VISAKHAPATNAM DISTRICT.

GENERAL MANAGER
SPECIAL PROJECTS
SPECIAL MANAGERS

ASSOCIATED
PROJECTS
SPECIAL MANAGERS

1950

1950