

SITE PLAN OF SPECIAL PLOT NO : 14A IN INDUSTRIAL PARK PHASE - II
PEDDAPURAM, EAST GODAVARI DISTRICT.

PLOT AREA : 4105.40 Sqm

INCLUDED : 



SCALE : 1 : 1000

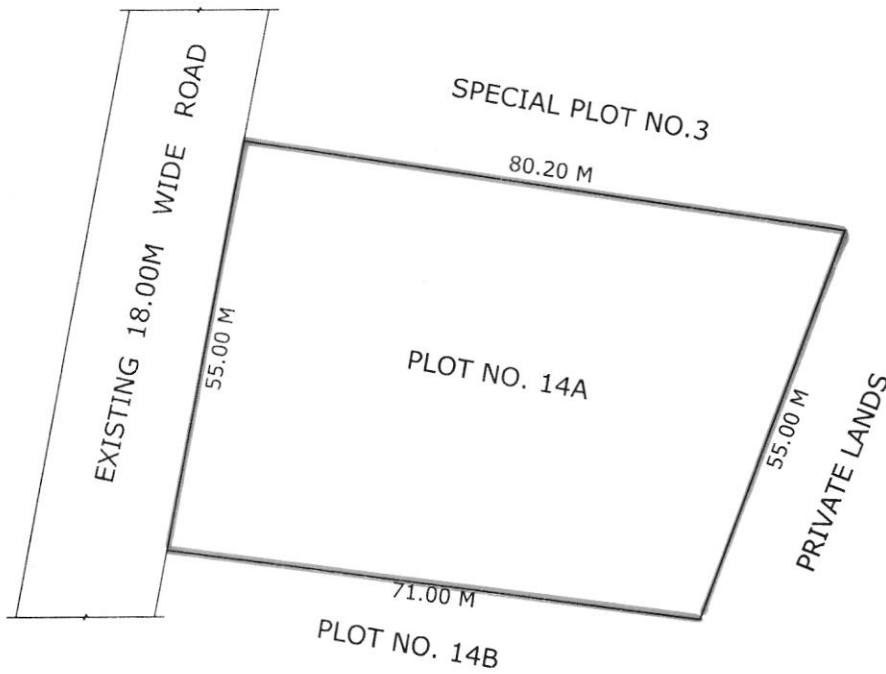

REFERENCE

NORTH : SPECIAL PLOT NO.3

SOUTH : PLOT NO. 14B

EAST : PRIVATE LAND

WEST : EXISTING 18.0M WIDE ROAD

Handwritten signature
PE/APIC/KKD

Handwritten signature
16-06-2016
DY. Zonal Manager (E)
APIC Ltd KAKINADA 5