

SITE PLAN OF SPECIAL PLOT NO : 14B IN INDUSTRIAL PARK PHASE - II
PEDDAPURAM, EAST GODAVARI DISTRICT.

PLOT AREA : 3718.10 Sqm

INCLUDED : 



SCALE : 1: 1000

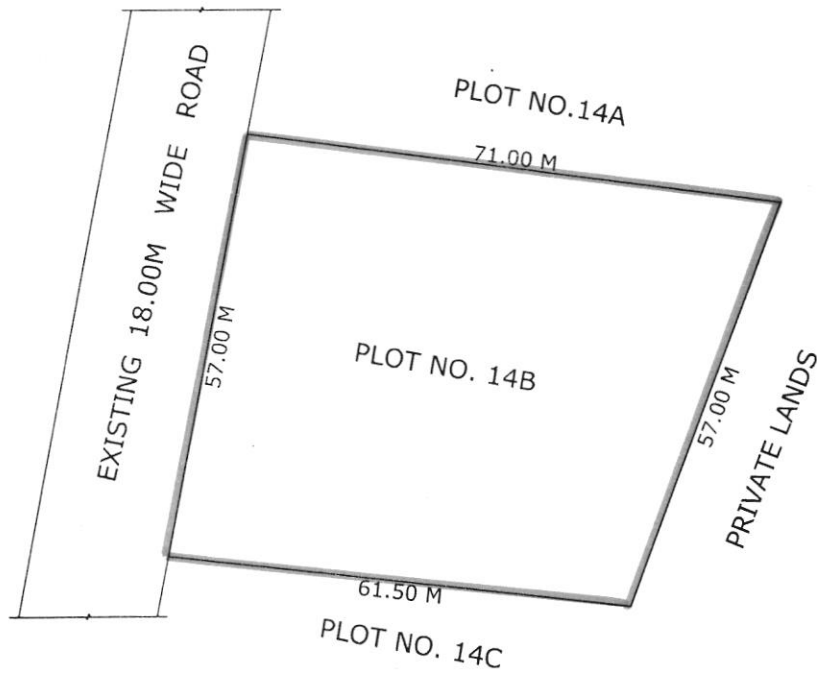

REFERENCE

NORTH : PLOT NO. 14A

SOUTH : PLOT NO. 14C

EAST : PRIVATE LAND

WEST : EXISTING 18.0M WIDE ROAD

cludo
PE/APIIC/KKD

16-06-2016
DY. Zonal Manager
APIIC Ltd KAKINADA.5