

232

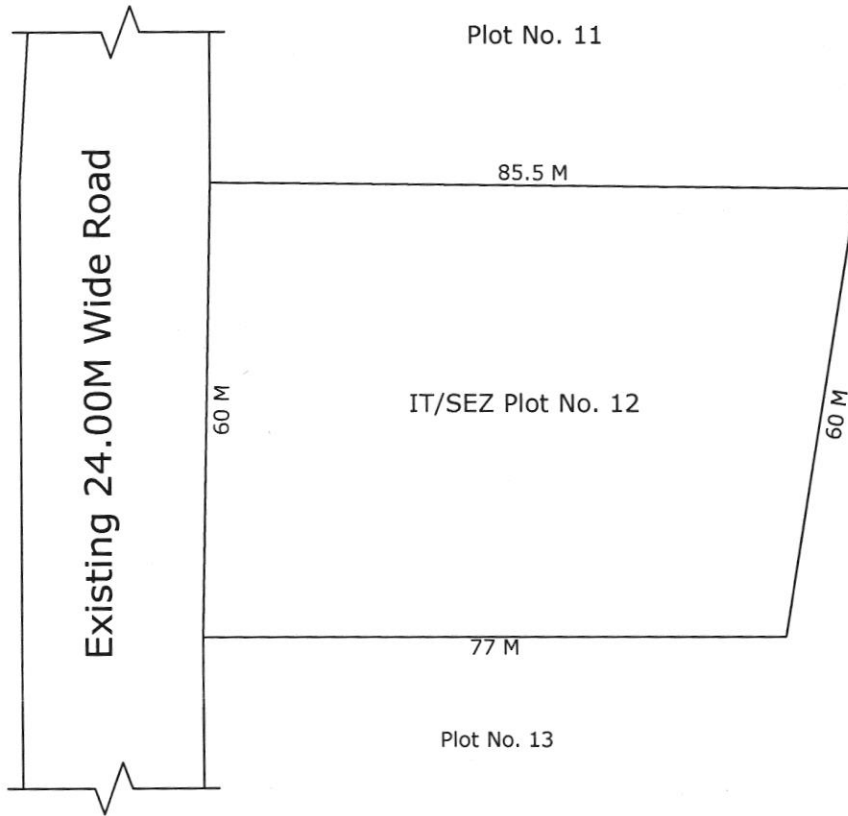
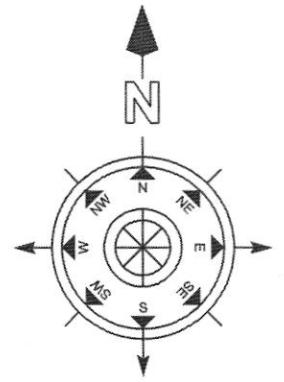

SCALE 1:10

Plot No 12

Plot's Area:- 4844.36 Sq. Mts.,

North :- Plot No. 11
 South :- Plot No. 13
 East :- APIIC Housing Plots & Compound Wall
 West :- Existing 24.00M Wide Road

IT/SEZ OF **Kakinada**
 SURVEY NO :
 G/MC/MCP :
 REVENUE MANDAL:Kakinada
 DISTRICT:EAST GODAVARI

This site plan is submitted subject to approval of revised layout plan by DTCP, Hyderabad.

The measurements were actually taken and boundaries of the plot were demarcated on the ground by me and shown to Sri K.B. Sankara Kumar, Manager (AM)

J. Srinivasan
J. SRINIVAS, 6/10/08
 Project Engineer
 APIIC LTD., KAKINADA

M. Sankar 6/9/2008
DY. Zonal Manager (E)
APIIC Ltd KAKINADA.5