

SITE PLAN OF PLOT NO - 11, MSME PARK, PEDDAPURAM E.G. DIST.,
PLOT AREA :- 300.00 SQM
SY.NO. 435(P)

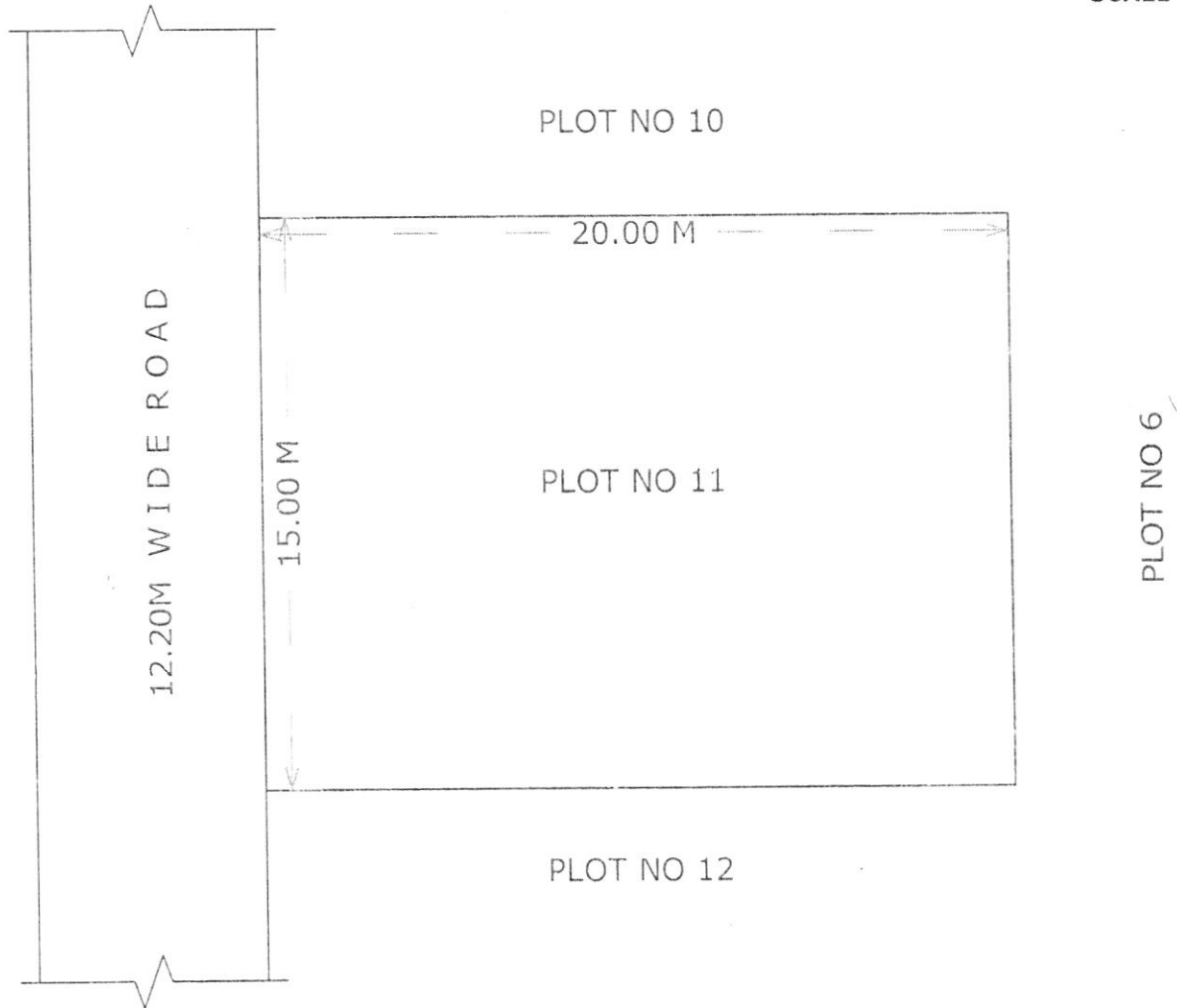

BOUNDARIES:-

| | | |
|-------|----|------------------|
| NORTH | :- | PLOT NO - 10 |
| SOUTH | :- | PLOT NO - 12 |
| EAST | :- | PLOT NO - 6 |
| WEST | :- | 12.20M WIDE ROAD |

NOTE :- THIS SITE PLAN IS SUBMITTED SUBJECT TO APPROVAL OF LAYOUT PLAN BY GUDA, KAKINADA

[Signature]
19/10/19
Project Engineer
APIIC Limited, Kakinada

[Signature]
19/10/19
DY. ZONAL MANAGER(E)
APIIC Limited, Kakinada