

SITE PLAN OF PLOT NO -23, AT TRADITIONAL FOOD PARK, PEDDAPURAM,
E.G.DIST.,

PLOT AREA :- 300.00 SQM

SY. NO. - 85(P)

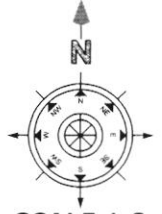

SCALE 1:2

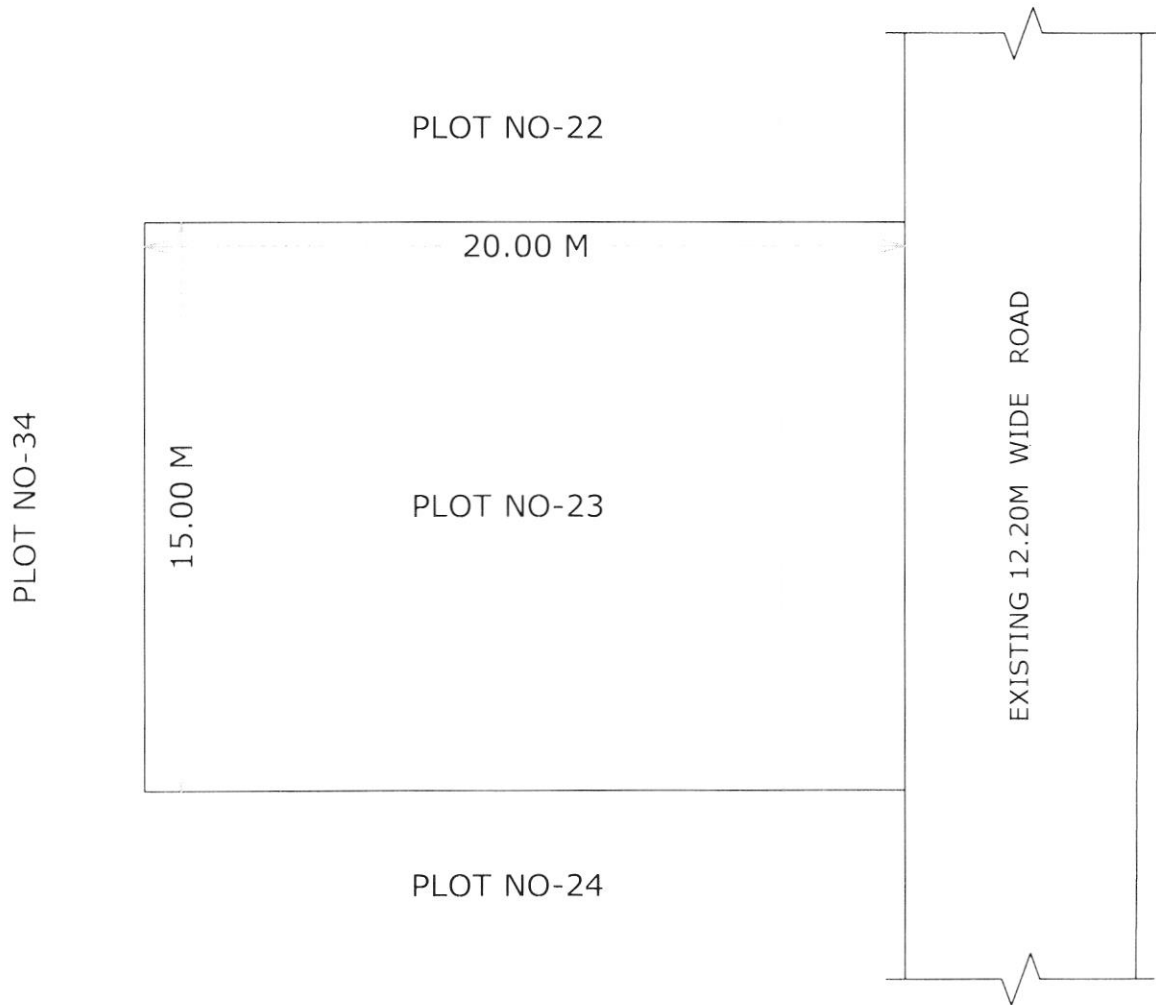

BOUNDARIES:-

NORTH	:-	PLOT NO-22
SOUTH	:-	PLOT NO-24
EAST	:-	EXISTING 12.20M WIDE ROAD
WEST	:-	PLOT NO-34

1. The Site Plan is submitted to approval of Final Layout Plan by GUDA, Kakinada
2. This Site Plan is prepared as per the Instructions of Higher Authority.

bslrb
= 16/2/24
Manager (E)
APIIC Limited, Kakinada

H. S. S. S.
16/2/24
Dy. Zonal Manager (E)
APIIC Limited, Kakinada

K. S. S.
Zonal Manager
APIIC Limited, Kakinada